

ESSEX COUNTY

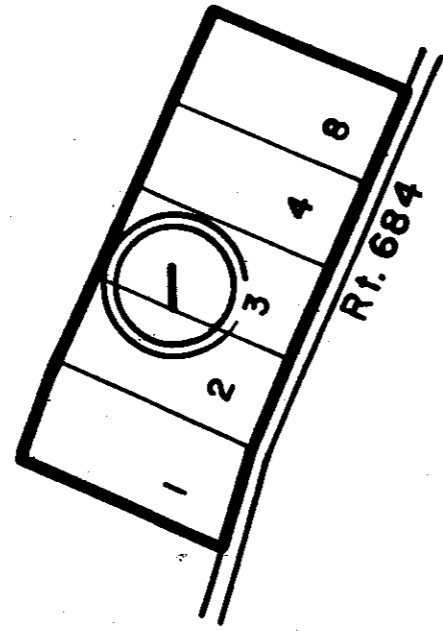

① W.C. JOHNSON LOTS-PB. 7, Pg. 110

REV. 65, 1/66, 1/82, 7/95, 12/00  
SCALE IN FEET



RAPPAHANNOCK DISTRICT

SECTION \_\_\_\_\_  
INSERT 53F

VIRGINIA STATE DEPARTMENT OF TAXATION, DIVISION OF REAL ESTATE APPRAISAL AND MAPPING